

High tensile swivel hook for steel wire rope on roller bearings - art. 3220/C

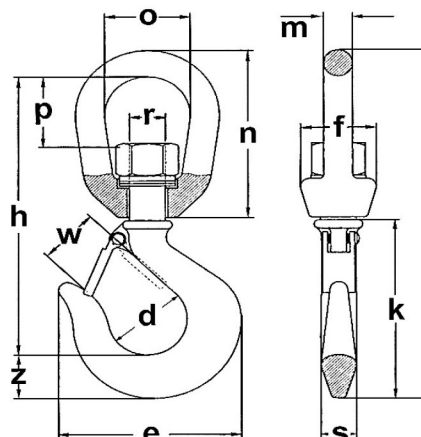

* Reference standard	Industrial standard
* Type of steel	Hook: 39NiCrMo3 steel quenched and tempered, class 8 Swivel: C 40 steel, class 5
* Design factor	4 : 1
* Standard surface	Red RAL 3001 painted, safety latch set electro galvanized
* Technical features	High capacity, small dimensions
* Applications	Lifting and handling of loads in industry and marine
* Warnings	They can swivel under load - the stated WLL applies for load resting on the bottom of hook; tip or side loads affect it greatly - never use hook with missing or damaged safety latch - please refer to the technical part of fittings section for deepening and other warnings

Dimensional tolerances

The dimensional tolerances for forged pieces according to norm UNI EN 10243-1 apply

Technical data

code	type of steel	WLL t *	Dimensions mm														appr. weight per pc. kg
			open. w	height h	open. o	height p	dia. d	width e	bar m	height i	thread n	height k	thread r	dia. f	thickness s	z	
VSGGS0125	alloy	1,25	25	114	32	32	30	73	10	142	64	77	M12	25	14	18	0,45
VSGGS0160	alloy	1,6	27	136	38	32	32	81	13	170	82	86	M16	34	16	21	0,77
VSGGS0250	alloy	2,5	29	156	46	40	35	92	16	198	99	94	M18	38	19	26	1,22
VSGGS0320	alloy	3,2	32	173	50	45	38	104	18	220	110	106	M20	48	22,5	29	1,51
VSGGS0540	alloy	5,4	38	205	57	53	46	125	20	262	127	133	M22	54	28,5	37	2,48
VSGGS0800	alloy	8	48	243	68	57	60	166	26	315	146	167	M27	60	35	46	6,06
VSGGS1100	alloy	11,5	58	285	75	63	76	193	29	372	159	210	M30	66	44	58	9,94
VSGGS1500	alloy	16	67	322	90	73	82,5	225	32	420	183	234	M36	76	52	66	15,00
VSGGS2200	alloy	20	81	424	120	105	108	285	40	549	257	288	M52	105	64	85	20,64
VSGGS3000	alloy	30	102	533	135	118	127	350	45	673	293	377	M60	124	75	95	28,79

* metric tons of 1.000 kg

The sizes in bold character are stock-items.